

2 UNITS MODULAR HOUSING (MM 35) H 53 MM.  
 FOR MOUNTING ON OMEGA RAIL ACC. TO DIN EN 50022.  
 IT IS SUITABLE TO HOUSE ANALOGUE AND DIGITAL  
 INSTRUMENTATION. SCREWED OR SNAP-IN LOCKING  
 BETWEEN BASE AND COVER. SUITABLE TO HOUSE FIXED OR  
 DETACHABLE TERMINALS OF ANY MOUNTING STEP.  
 CUSTOM DRILLING ON ANY SIDE (WINDOWS, HOLES, SLOTS).  
 MADE OF NORYL CLASS V2 OR, ON REQUEST, CLASS V0 (UL  
 94) IN RAL (7035) GREY.

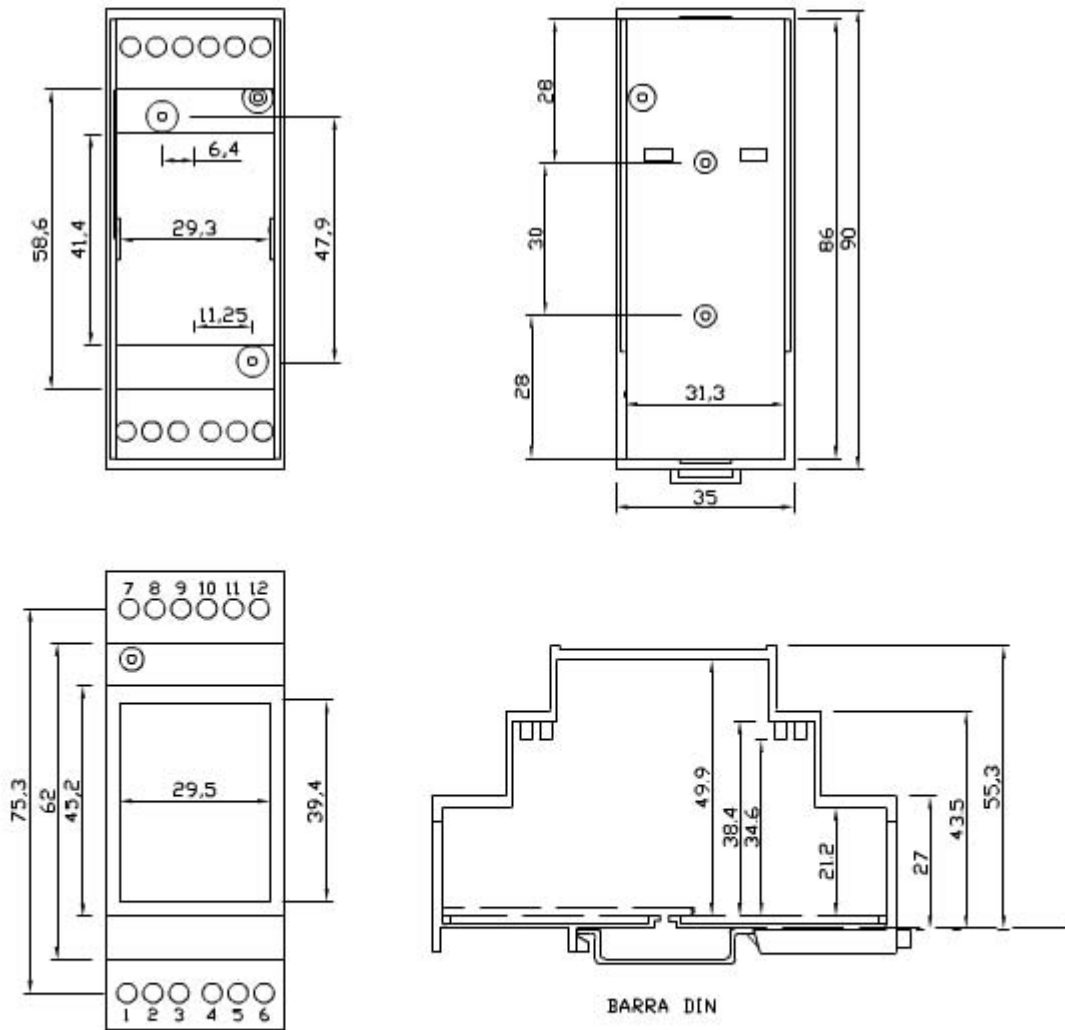

[Print](#)

[Close](#)